

**2010 BOSTON  
RV & OUTDOOR EXPO  
JANUARY 15-18, 2010**

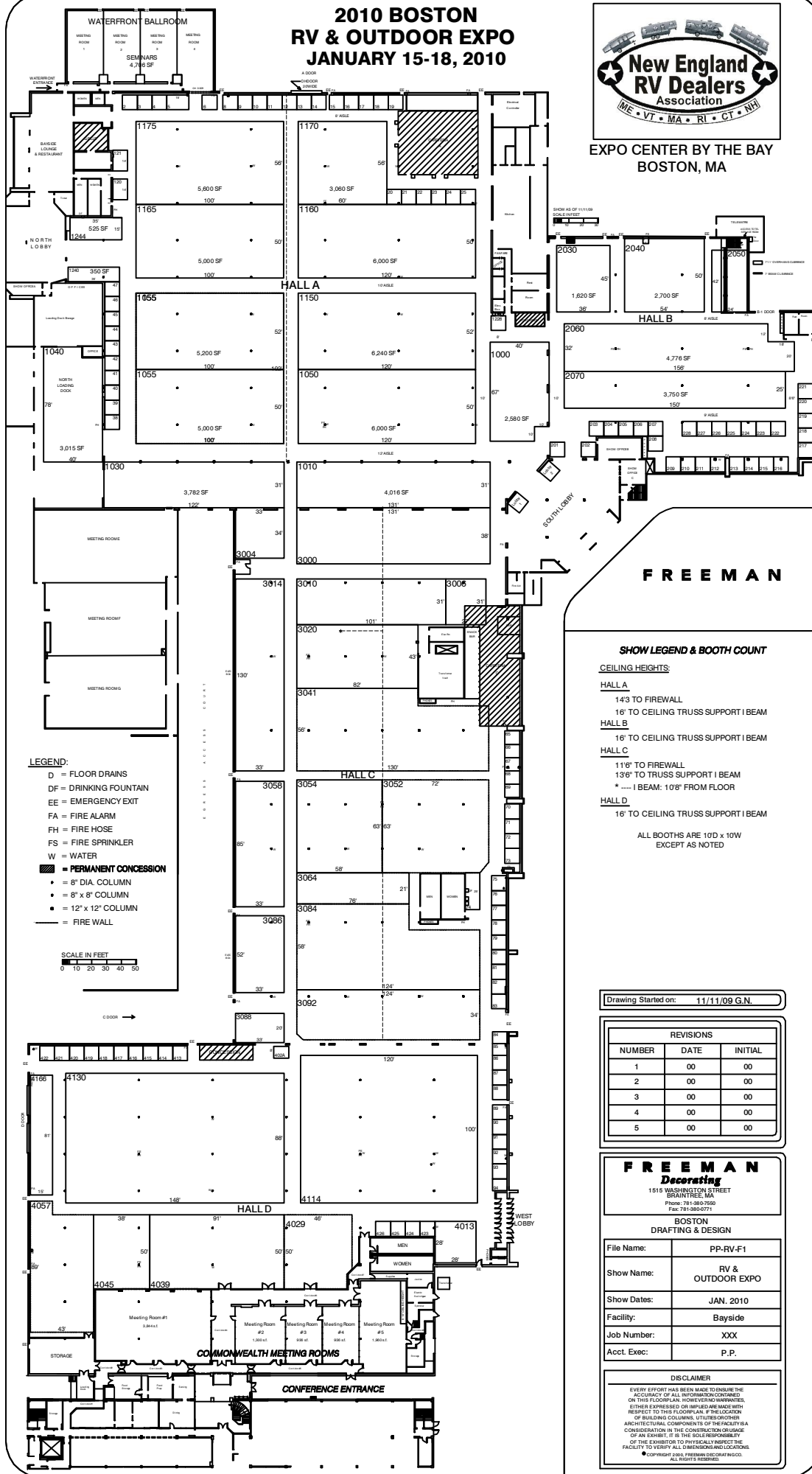

**EXPO CENTER BY THE BAY  
BOSTON, MA**



- LEGEND:**
- D = FLOOR DRAINS
  - DF = DRINKING FOUNTAIN
  - EE = EMERGENCY EXIT
  - FA = FIRE ALARM
  - FH = FIRE HOSE
  - FS = FIRE SPRINKLER
  - W = WATER
  - = PERMANENT CONCESSION
  - = 8" DIA. COLUMN
  - ◻ = 8" x 8" COLUMN
  - ◻ = 12" x 12" COLUMN
  - = FIRE WALL

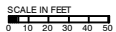

**FREEMAN**

**SHOW LEGEND & BOOTH COUNT**

- CEILING HEIGHTS:**
- HALL A**  
14'3" TO FIREWALL  
16' TO CEILING TRUSS SUPPORT I BEAM
  - HALL B**  
16' TO CEILING TRUSS SUPPORT I BEAM
  - HALL C**  
11'6" TO FIREWALL  
13'6" TO TRUSS SUPPORT I BEAM  
\* --- I BEAM: 10'8" FROM FLOOR
  - HALL D**  
16' TO CEILING TRUSS SUPPORT I BEAM
- ALL BOOTHS ARE 10'0" x 10'  
EXCEPT AS NOTED

Drawing Started on: 11/11/09 G.N.

| REVISIONS |      |         |
|-----------|------|---------|
| NUMBER    | DATE | INITIAL |
| 1         | 00   | 00      |
| 2         | 00   | 00      |
| 3         | 00   | 00      |
| 4         | 00   | 00      |
| 5         | 00   | 00      |

**FREEMAN  
Decorating**  
1515 WASHINGTON STREET  
GRAINTREE, MA  
Phone: 781-880-7050  
Fax: 781-880-0771

**BOSTON  
DRAFTING & DESIGN**

|             |                      |
|-------------|----------------------|
| File Name:  | PP-RV-F1             |
| Show Name:  | RV &<br>OUTDOOR EXPO |
| Show Dates: | JAN. 2010            |
| Facility:   | Bayside              |
| Job Number: | XXX                  |
| Acct. Exec: | P.P.                 |

**DISCLAIMER**

EVERY EFFORT HAS BEEN MADE TO ENSURE THE ACCURACY OF ALL INFORMATION CONTAINED ON THIS FLOORPLAN. HOWEVER, NO WARRANTIES, EITHER EXPRESSED OR IMPLIED ARE MADE WITH RESPECT TO THIS FLOORPLAN. THE LOCATION OF BUILDING COLUMNS, UTILITIES OR OTHER ARCHITECTURAL COMPONENTS OF THE FACILITY IS A CONSIDERATION IN THE CONSTRUCTION OR USAGE OF AN EXHIBIT. IT IS THE SOLE RESPONSIBILITY OF THE EXHIBITOR TO PHYSICALLY INSPECT THE FACILITY TO VERIFY ALL DIMENSIONING LOCATIONS.

© COPYRIGHT 2009, FREEMAN DECORATING CO., ALL RIGHTS RESERVED.